

Panther Grove 2

	10-Jul-26	Today
Daily Weather as of 7:00am	0	0
Low Temperature (F)	66	63
High Temperature (F)	84	82
Ground Wind Speed (MPH):	8 MPH	9 MPH
Precipitation (in)	0.80	24%
July Precip Total (in)	2.50	

Daily Safety Topics
SPO/SSE questionnaire update - the questions have now been updated to reflect more accurate assessments.
Housekeeping- reminder when possible clean as you go. Help keep trash from flying in the farmers fields.
Site Notes



Saturday, July 11, 2026

ACTIVITY	LAST WORKING DAY	TODAY	NEXT WORKING DAY
	Friday, July 10, 2026	Saturday, July 11, 2026	Monday, July 13, 2026
LOCATION(S)	LOCATION(S)	LOCATION(S)	LOCATION(S)
Road Closures (Curing Roads)	1600N:400E-CH16 (Cure complete, Protecting base before agg cap) 1600N:500E-600E (Cure complete, Protecting base before agg cap) 1600N:700E-800E (Cure complete, Protecting base before agg cap) 200E:1800N-1900N (Cure complete, Protecting base before agg cap) 1800N:100E-200E ((Cure complete, Protecting base before agg cap) 1800N:200E-300E (Cure complete, Protecting base before agg cap) 200E:1800N-IL116 (Cure complete, Protecting base before agg cap)	1600N:400E-CH16 (Cure complete, Protecting base before agg cap) 1600N:500E-600E (Cure complete, Protecting base before agg cap) 1600N:700E-800E (Cure complete, Protecting base before agg cap) 200E:1800N-1900N (Cure complete, Protecting base before agg cap) 1800N:100E-200E ((Cure complete, Protecting base before agg cap) 1800N:200E-300E (Cure complete, Protecting base before agg cap) 200E:1800N-IL116 (Cure complete, Protecting base before agg cap)	1600N:400E-CH16 (Cure complete, Protecting base before agg cap) 1600N:500E-600E (Cure complete, Protecting base before agg cap) 1600N:700E-800E (Cure complete, Protecting base before agg cap) 200E:1800N-1900N (Cure complete, Protecting base before agg cap) 1800N:100E-200E ((Cure complete, Protecting base before agg cap) 1800N:200E-300E (Cure complete, Protecting base before agg cap) 200E:1800N-IL116 (Cure complete, Protecting base before agg cap)
Road Closures (Pipe Culverts)	1600N:500E-600E (Unmarked Culvert Replacement) 1600N:600E-700E (Unmarked Culvert Replacement) 1600N:700E-800E (Unmarked Culvert Replacement)	1600N:700E-800E (UC3-1002-20260627) 1300N:600E-700E (79,80)	700E:1300N-1400N (81) 700E:CH8-1300N (81) 1300N:700E-600E (81, 78)
Public Roads			
Road Closures		1600N:500E-600E (Profile Adjustment at UC1/Pulv) 1600N:600E-700E (Profile Adjustment at UC2/Pulv) 1600N:700E-800E (Profile Adjustment at UC3/Pulv)	1600N:500E-600E (Pulv/Stab) 1600N:600E-700E (Pulv/Stab) 1600N:700E-800E (Pulv/Stab)
Culvert Work	UC1-1001-20260627 UC2-1002-20260627	UC3-1002-20260627 79, 80	81, 78
Road Pulverization	Delayed- Unmarked Culvert Work	Delayed- Unmarked Culvert Work	1600N:500E-600E 1600N:600E-700E 1600N:700E-800E
Cement Stabilization	Delayed- Unmarked Culvert Work	Delayed- Unmarked Culvert Work	1600N:500E-600E 1600N:600E-700E 1600N:700E-800E
Agg Surface Install			
Oil and Chip			
Earthen Shoulders			
Aggregate Widening			
Strip Public Road Radii			
Mowing Public Road Radii	(Hwy16+1600) (Hwy16+1000)		
Stone Public Road Radii			
Strip Access Road			
Cement Stabilization	T40,T85,T27		
Stone Access Road			
Strip Access Road Radii			T41 (CH16:1000-1100)
Access Roads			
Stone Access Road Radii	T41 (CH16:1000-1100)(C) T38 (CH16:1000-1100)(C) T36 (CH16:1100-1200)(C) T35 (CH16:1200-1300)(C) T39 (CH16:1300-1400)(C) T85 (CH16:1300-1400)(C) T40 (CH16:1500-1600)(C) T27 (CH16:1500-1600)(C) T37 (CH16:1600-1700)(C)		T41 (CH16:1000-1100) T38 (CH16:1000-1100) T36 (CH16:1100-1200) T35 (CH16:1200-1300) T39 (CH16:1300-1400) T85 (CH16:1300-1400) T40 (CH16:1500-1600) T27 (CH16:1500-1600) T37 (CH16:1600-1700)

Quantity Tracking				
QTY LAST WORKDAY	QTY TO DATE	UNIT	TOTAL QTY	% COMPLETE
	22	EA	222	9.9%
	17740	LF	374014	4.7%
	14978	LF	374014	4.0%
	0	LF	374014	0.0%
	0	LF	374014	0.0%
	0	LF	374014	0.0%
	0	EA	35	0.0%
	0	EA	35	0.0%
	0	LF	161120	0.0%
5734	12945	LF	161120	8.0%
	0	LF	161120	0.0%
	10	EA	TBD	#VALUE!
	9	EA	TBD	#VALUE!

Site Information	
Manpower	
4	White Construction Management
15	White Construction Operators
10	White Construction Laborers
	White Construction Ironworkers
	White Construction Millwright
	White Construction Electrician
15	Dunn Company
	West Wind
5	Tobey's Construction & Cartage
49	Total
Equipment	
10	Pickup Trucks
2	Dozers
3	Skid Steers
2	Rollers
2	Graders
2	Cargo Trailer
0	Cranes
1	Excavators
0	Forklift
3	Trailers
1	Sand Truck
2	Sheepfoot Roller
2	Reclaimer Stabilizer
2	Smooth Drum Roller
3	Water Trucks
35	Total

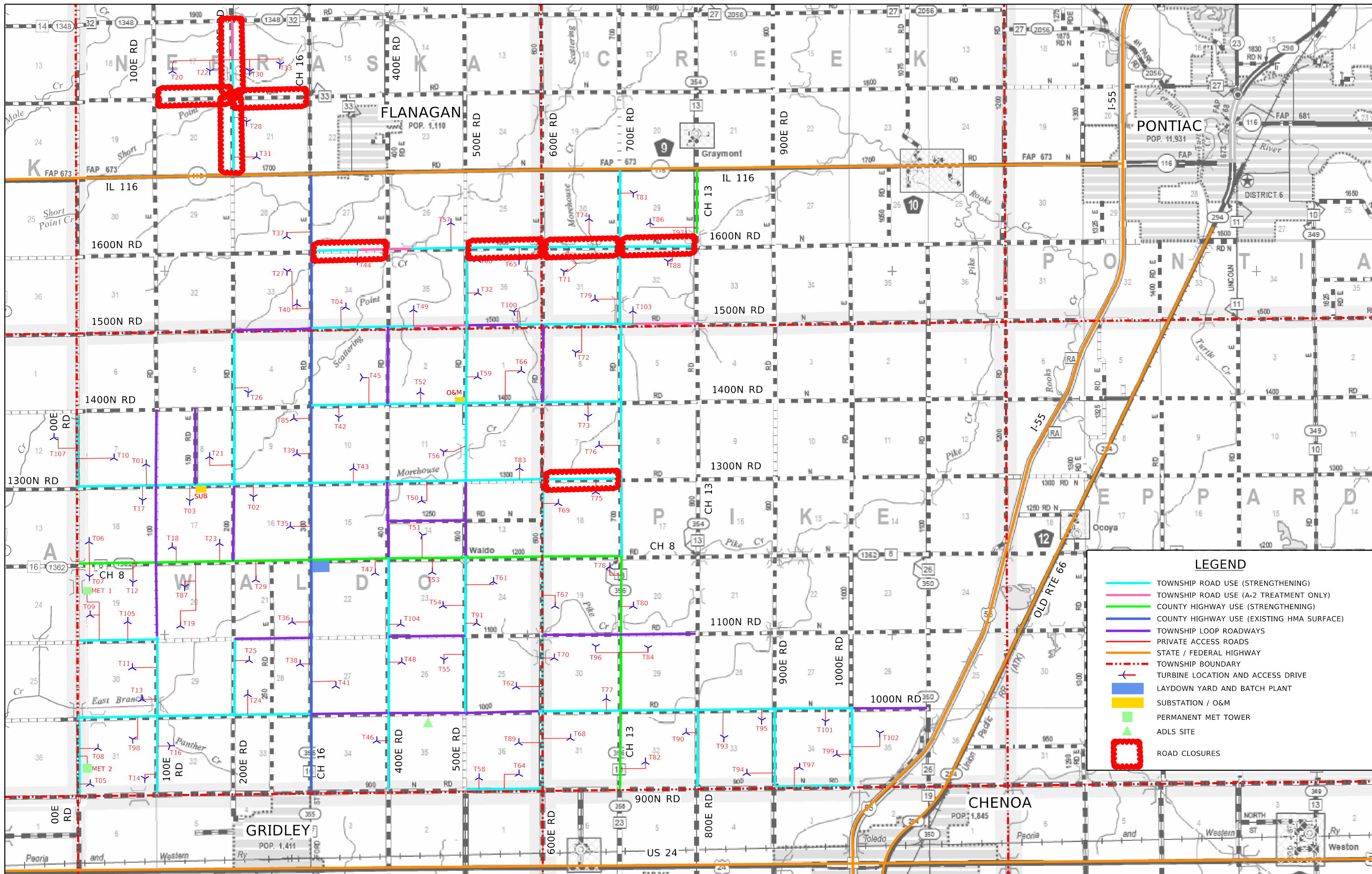

LEGEND

- TOWNSHIP ROAD USE (STRENGTHENING)
- TOWNSHIP ROAD USE (A-2 TREATMENT ONLY)
- COUNTY HIGHWAY USE (STRENGTHENING)
- COUNTY HIGHWAY USE (EXISTING HMA SURFACE)
- TOWNSHIP LOOP ROADWAYS
- PRIVATE ACCESS ROADS
- STATE / FEDERAL HIGHWAY
- TOWNSHIP BOUNDARY
- + TURBINE LOCATION AND ACCESS DRIVE
- LAYDOWN YARD AND BATCH PLANT
- SUBSTATION / O&M
- PERMANENT MET TOWER
- ▲ ADLS SITE
- ROAD CLOSURES

REV	DATE	DESCRIPTION
1	4/10/2026	REV 1
00	2/20/2026	IFC SUBMITTAL

DESIGNED - JDA	DATE - 07/08/2026
DRAWN - DRR/LNS	
CHECKED - ML	

**PANTHER GROVE 2 WIND PROJECT
LIVINGSTON COUNTY, ILLINOIS**

EXHIBIT A - PROJECT LAYOUT MAP (REVISION 1)

SCALE: N.T.S. SHEET 1 OF 1 SHEETS STA. TO STA.



TOTAL SHEETS	SHEET NO.	REVISION NO.
	1	

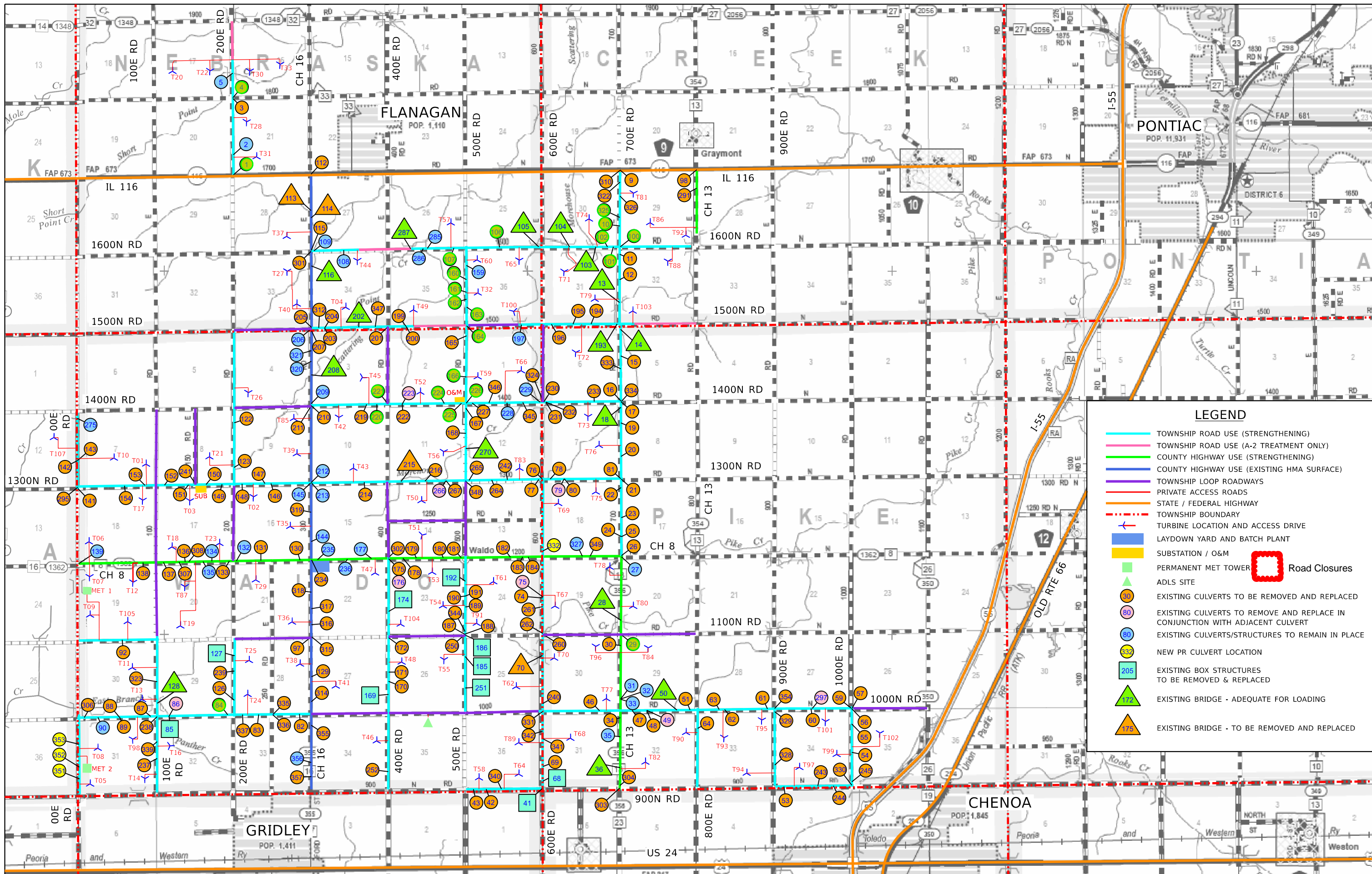

LEGEND

- TOWNSHIP ROAD USE (STRENGTHENING)
- TOWNSHIP ROAD USE (A-2 TREATMENT ONLY)
- COUNTY HIGHWAY USE (STRENGTHENING)
- COUNTY HIGHWAY USE (EXISTING HMA SURFACE)
- TOWNSHIP LOOP ROADWAYS
- PRIVATE ACCESS ROADS
- STATE / FEDERAL HIGHWAY
- TOWNSHIP BOUNDARY
- + TURBINE LOCATION AND ACCESS DRIVE
- LAYDOWN YARD AND BATCH PLANT
- SUBSTATION / O&M
- PERMANENT MET TOWER
- Road Closures
- ▲ ADLS SITE
- EXISTING CULVERTS TO BE REMOVED AND REPLACED
- EXISTING CULVERTS TO REMOVE AND REPLACE IN CONJUNCTION WITH ADJACENT CULVERT
- EXISTING CULVERTS/STRUCTURES TO REMAIN IN PLACE
- NEW PR CULVERT LOCATION
- EXISTING BOX STRUCTURES TO BE REMOVED & REPLACED
- ▲ EXISTING BRIDGE - ADEQUATE FOR LOADING
- ▲ EXISTING BRIDGE - TO BE REMOVED AND REPLACED

1	4/10/2026	REV 1	DESIGNED - JDA
00	2/20/2026	IFC SUBMITTAL	DRAWN - DRR/LNS
REV	DATE	DESCRIPTION	CHECKED - ML
			DATE - 04/14/2026

**PANTHER GROVE 2 WIND PROJECT
LIVINGSTON COUNTY, ILLINOIS**

EXHIBIT A - PROJECT LAYOUT MAP (REVISION 1)

SCALE: N.T.S. SHEET 1 OF 1 SHEETS STA. TO STA.



TOTAL SHEETS	SHEET NO.	REVISION NO.